

ADVANCING CAMPUS PRIORITIES THROUGH INFORMED SPACE ALLOCATIONS

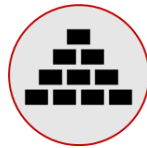

Progressive
Assessment

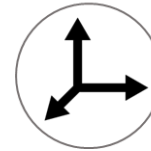

Assessment
Driven
Vision



Advancing
Priorities

Library Assessment Conference

11.02.16



Robert E. Fox, Jr.
Dean

Bruce L. Keisling
Associate Dean

“Our knowledge about **users** comes from reliable, relevant **data** related to their preferences, activities and **needs**, and this knowledge drives future changes.”

Vision to deploy assessment data with strategic opportunities.

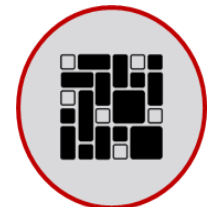

Users | Needs | Data

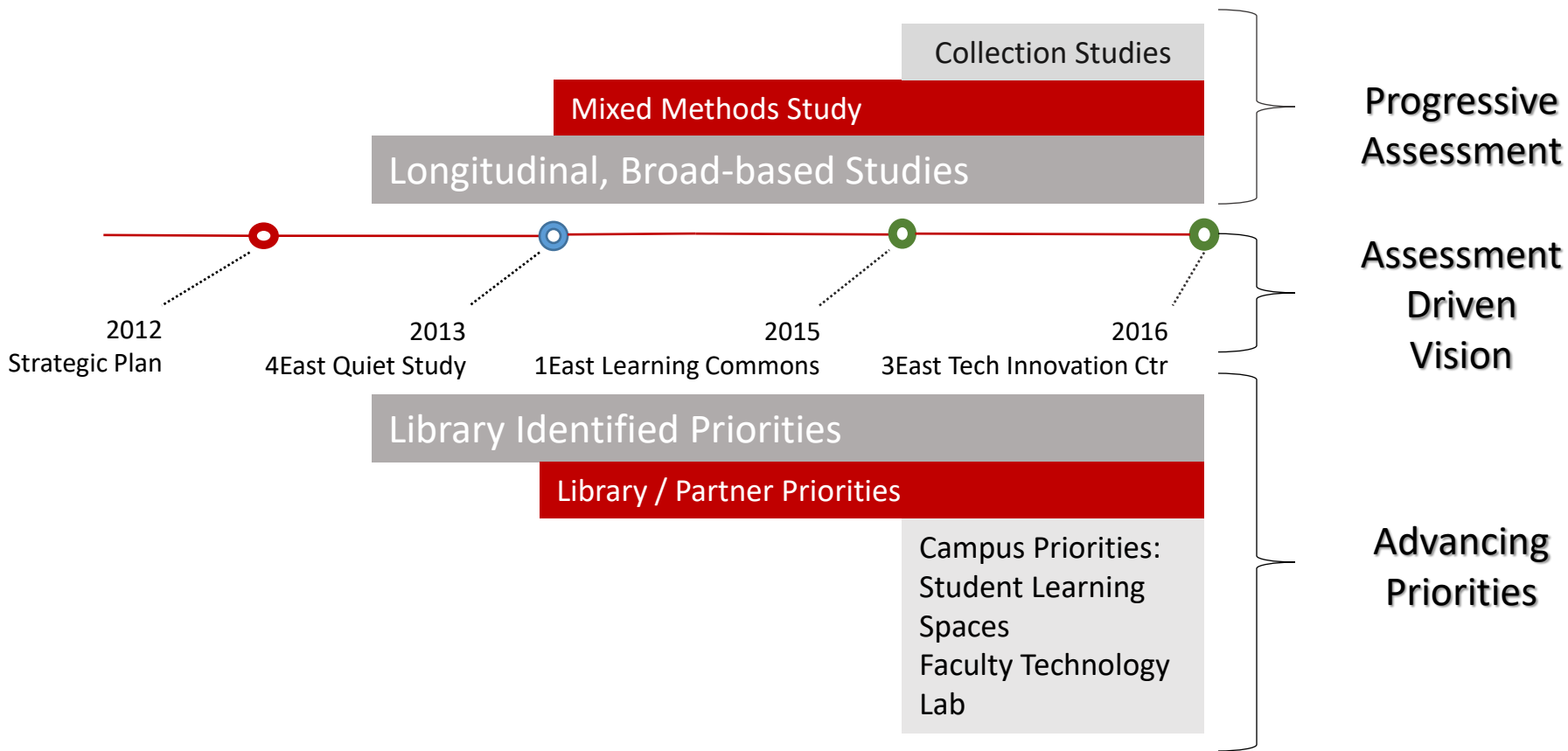

PROJECT



2015

1East Learning Commons

PROJECT QUICK FACTS



TIMING:

2013-14 Assessment
2015 Construction

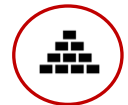

SCOPE:

21,121 sq. ft.
\$2.2 million budget

Progressive Assessment

Benchmark surveys followed by major Mixed Methods Study: observations, white boards, focus groups, design charrettes, datasets

Assessment Driven Vision

Centralize library service area, collocate student academic support services, create variety of group/individual spaces, improve natural light/lighting, improve sight lines/way finding

Advancing Priorities

Improve student learning spaces
Support student success
Enhance student recruiting

PROJECT



2015

1East Learning Commons

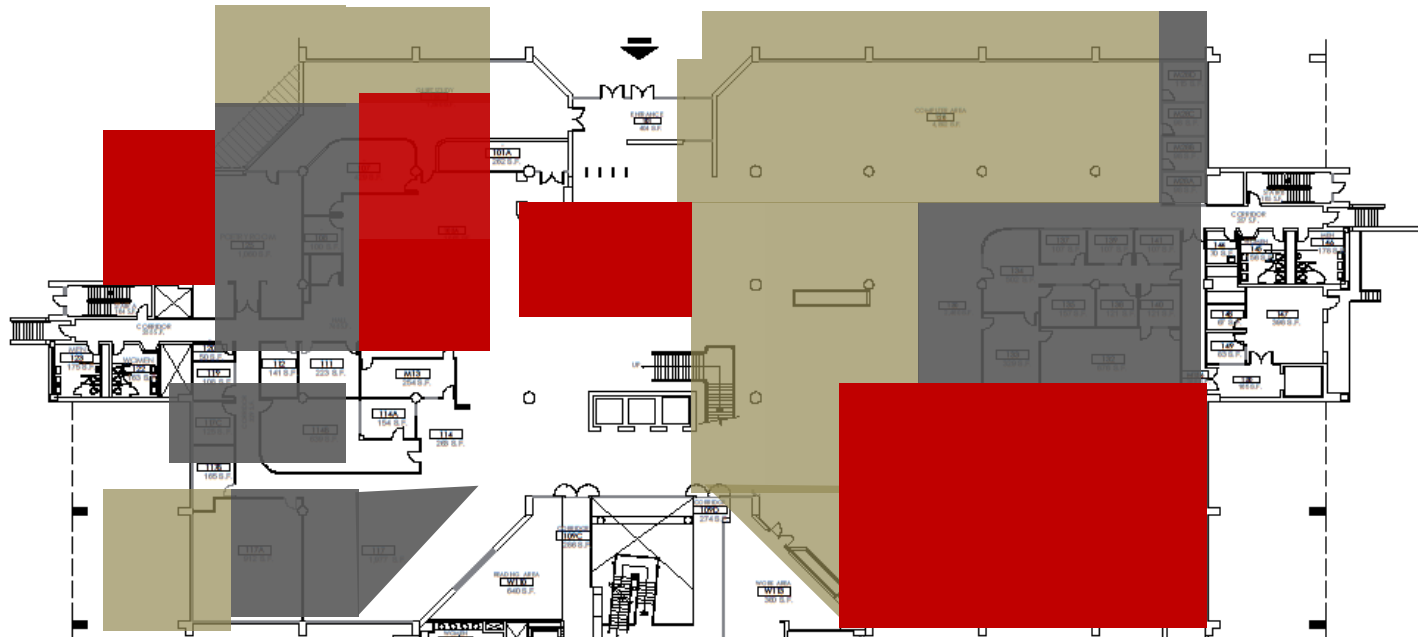

■ Collections ■ Services ■ User Spaces

Pre-construction space distributions

PROJECT



2015

1East Learning Commons

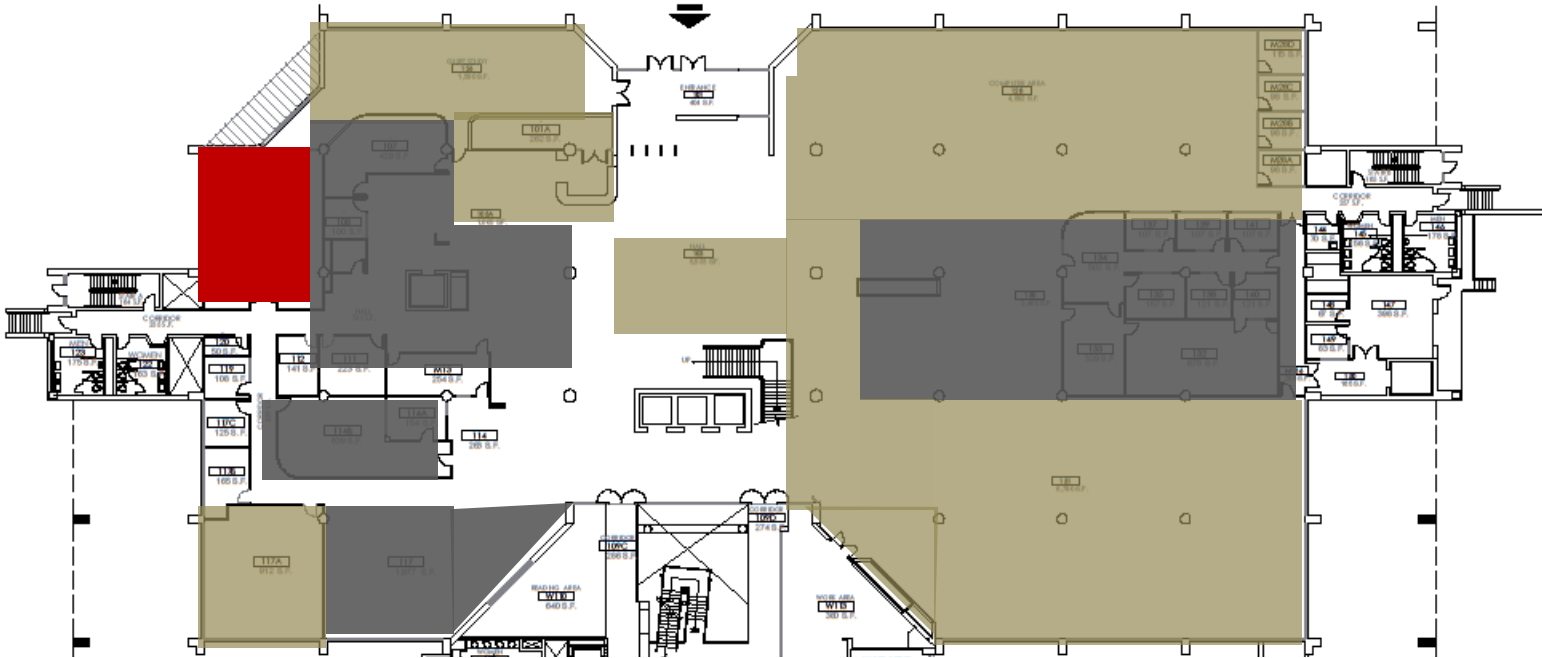

■ Collections ■ Services ■ User Spaces

Post-construction space distributions

PROJECT



2015

1East Learning Commons

Pre-2015 Allocations

■ Collections ■ Services ■ User Spaces

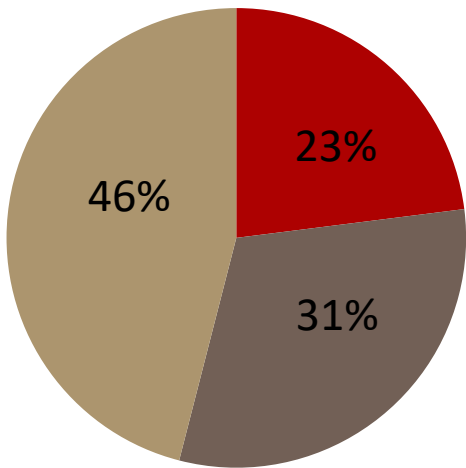

2015 Allocations

■ Collections ■ Services ■ User Spaces

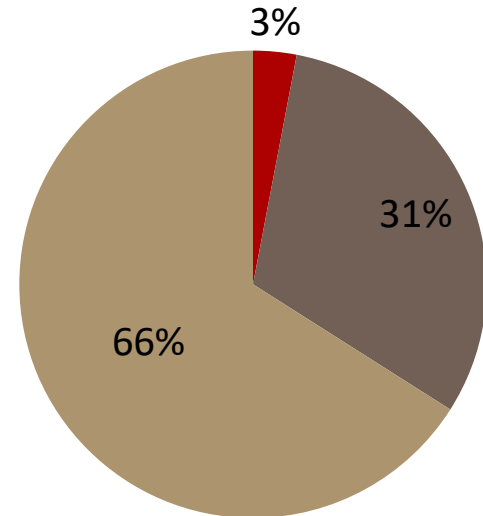

Assignable sq ft allocations

PROJECT

2016/2018 – 3East Tech Innovation Center & Improved Student Spaces

PROJECT QUICK FACTS



TIMING:

- 2015-16 Assessment
- 2016- Phase 1 Construction
- 2018- Phase 2 Construction



SCOPE:

- 35,000 sq. ft. (est.)
- Phase 1 - \$2.5 million budget
- Phase 2 - \$3.5 million budget

Progressive Assessment

Benchmark surveys and mixed methods study with collection usage and overlap studies

Assessment Driven Vision

Library: Overarching desire to create student learning spaces
Partner: Creating a faculty technology innovation center

Advancing Priorities

“Improve learning and study space”
“Create excellence in engaged teaching”



Increase Student Learning Spaces

Build on? *OR*
Change space utilization?

Change

How do you fund?

How do you clear space?

Central campus funding?

Building/Campus partner funding?

Reallocate:
Campus Partner

Store:
Robotic Retrieval

Deaccession:
Print journals

(Very) Limited

YES!

Generates funds

Need to expand

Need to purchase backfiles

Create pool of funds from external and internal sources to fund . . .

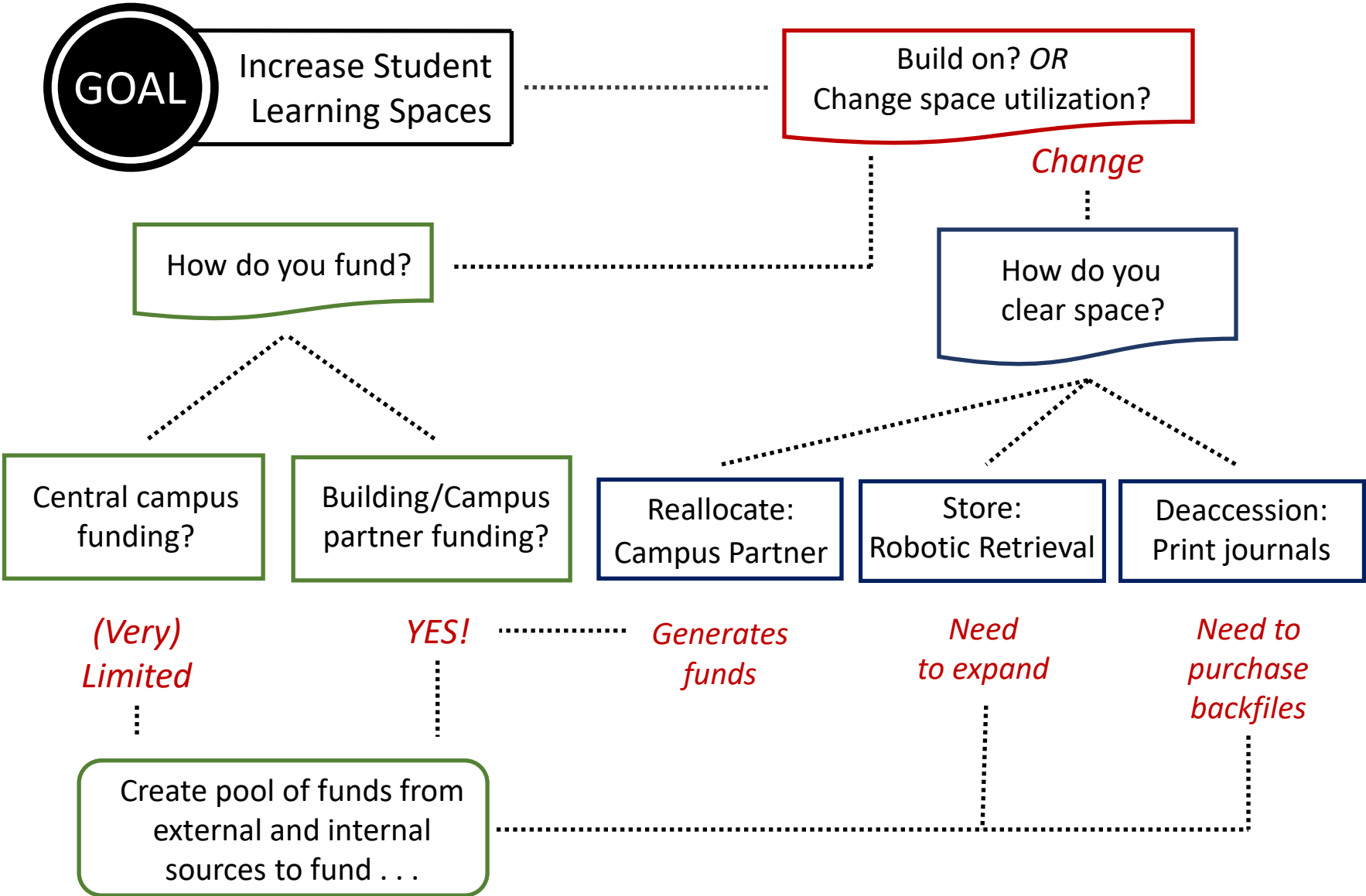

PROJECT

2016/2018 – 3 East
Tech Innovation Center &
Improved Student Spaces

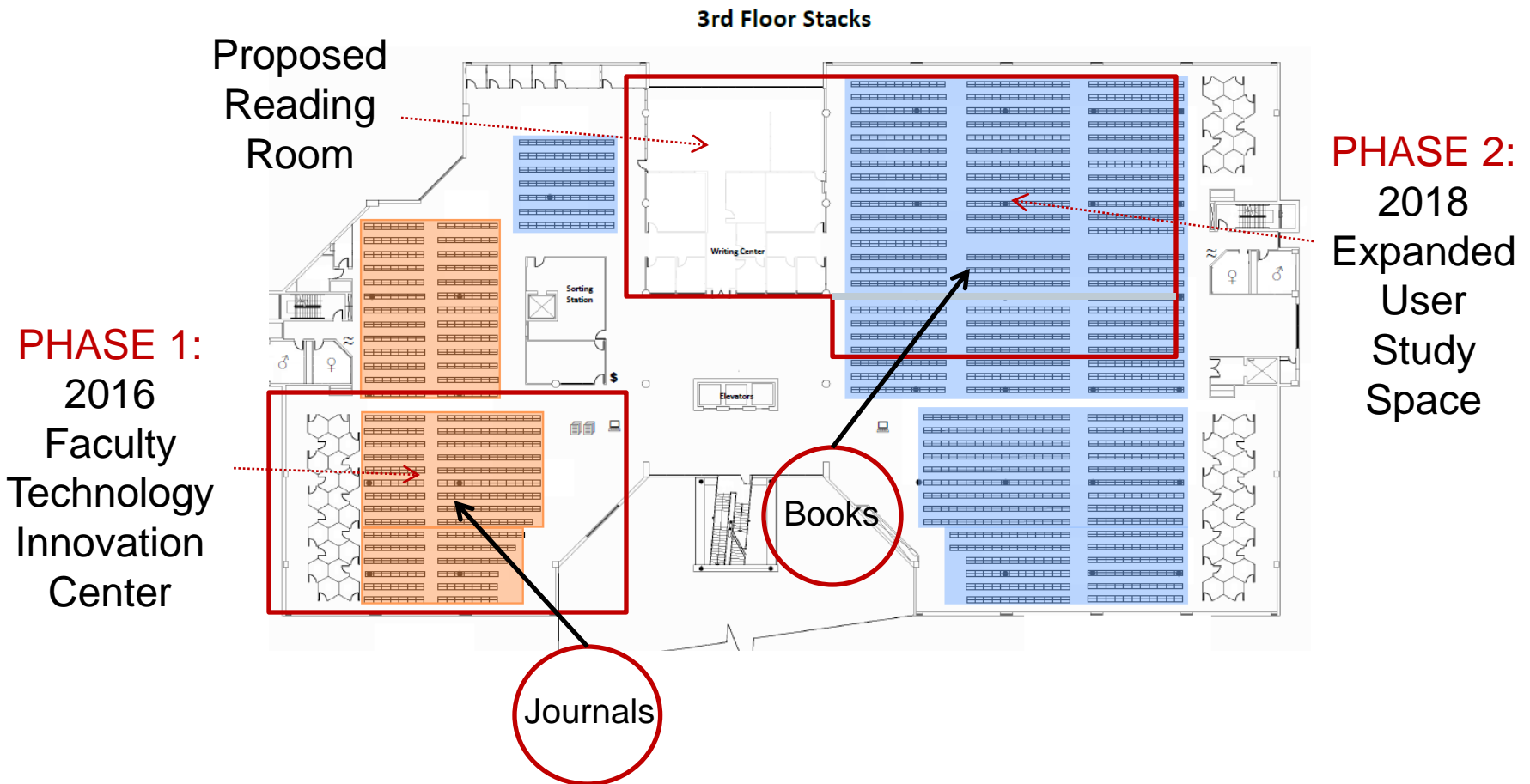



Decision Making with Data

- Scope of Collection Content
- Linear Feet of Shelving
- Deaccession Rates

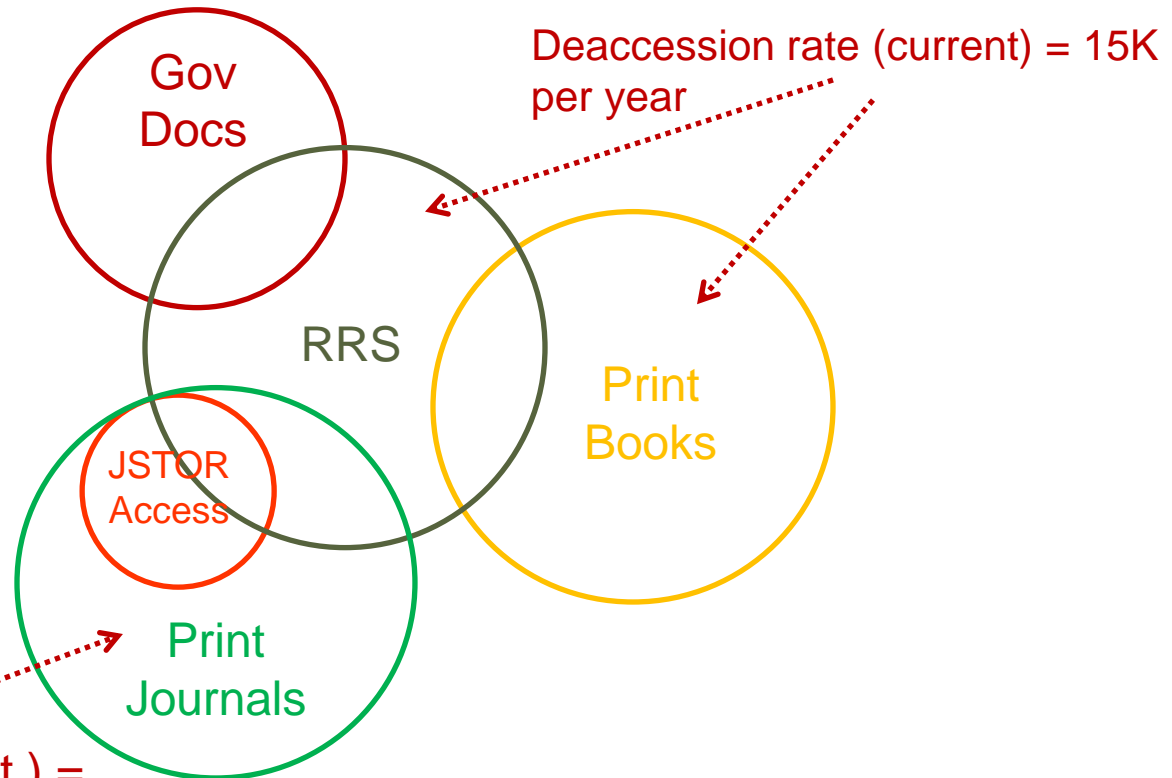

Decision Making with Data

- Print journals with access but not previously deaccessioned
- Print journals with online availability but no paid contractual access
- Cost per linear inch for purchase/access

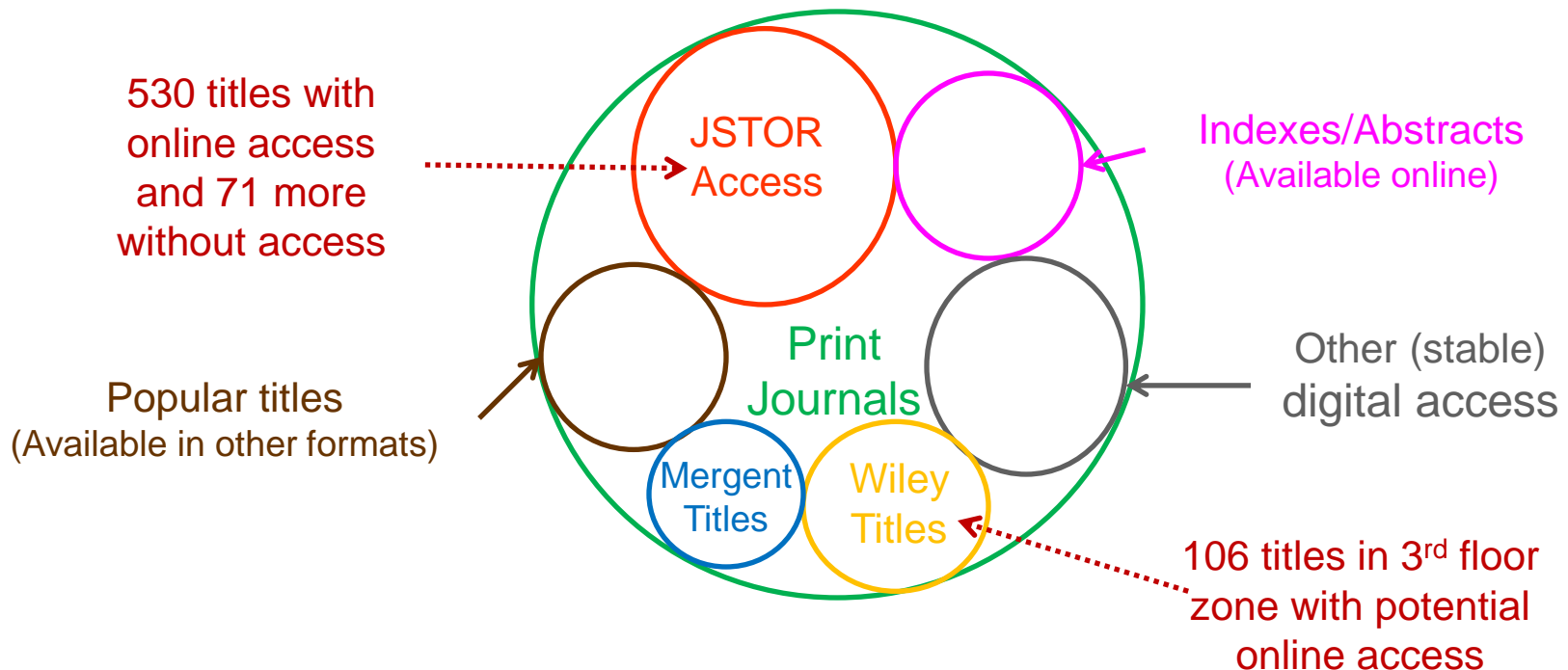

Decision Making with Data

Merging Quantitative Data with Qualitative Data



Review Data for JSTOR Title Matches

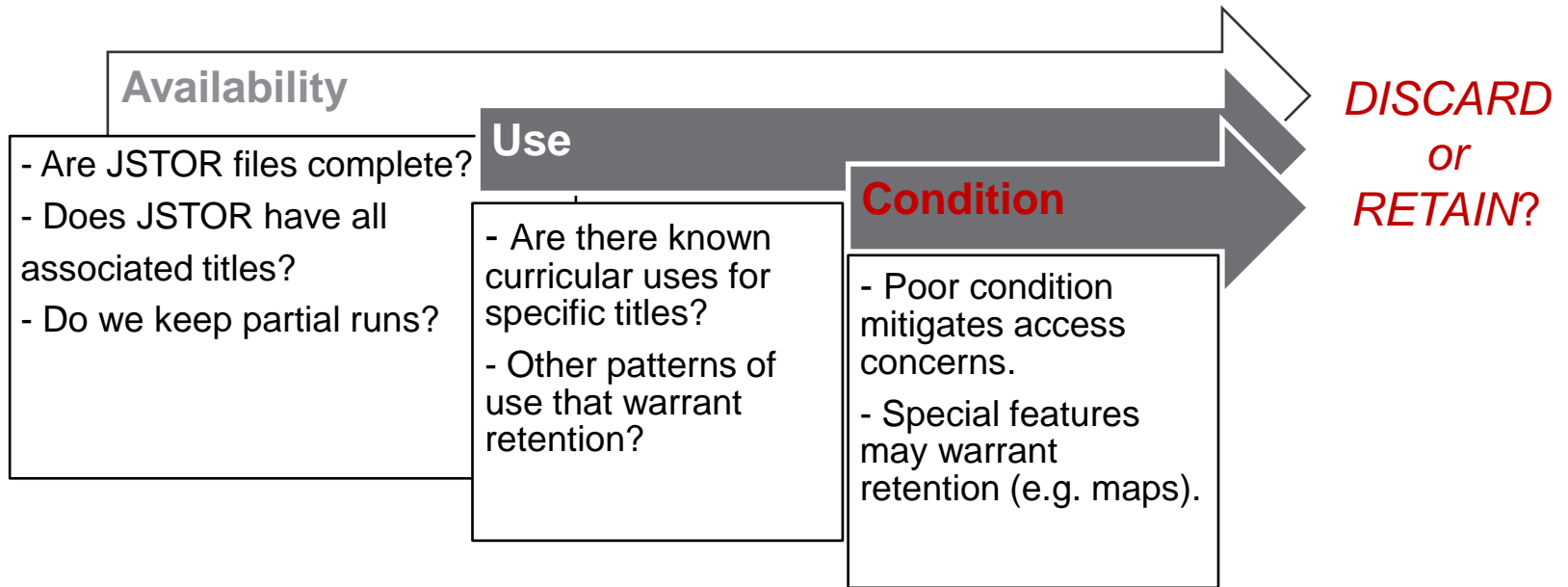

PROJECT



2016/2018 – 3 East
Tech Innovation Center &
Improved Student Spaces

How we
used – and
are using
data

- Purchased journal back files [JSTOR XI-XIV, Mergent, Wiley, and NEJM]
- Withdrew and recycled 50K volumes of print journals
- Committed to expand the Robotic Retrieval System [expanding capacity from 600K vols to 900K vols]
- Consulting with faculty about which journal formats to retain and which monographs to relocate

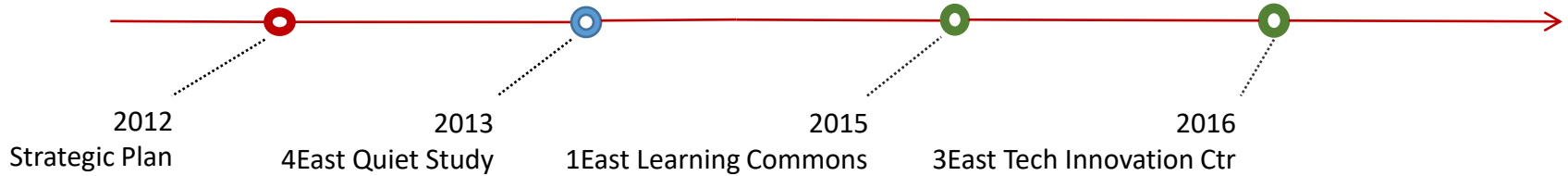

Project Summary
1East

Assessment Informed:
Space allocations
Personnel Resources
Financial Resources

Campus Priorities:
Improve student learning spaces
Support student success
Enhance student recruiting

Project Summary
3East

Assessment Informed:
Space Allocations
Personnel Resources
Financial Resources

Campus Priorities:
Improve learning and study space
Create excellence in engaged teaching